



Hitchins
since 1932



022-068
Eco-Friendly Building Material /
Minimum 20% Recycled Content

FORMDEX ADMIX

CRYSTALLIZATION WATERPROOFING
ADMIXTURE

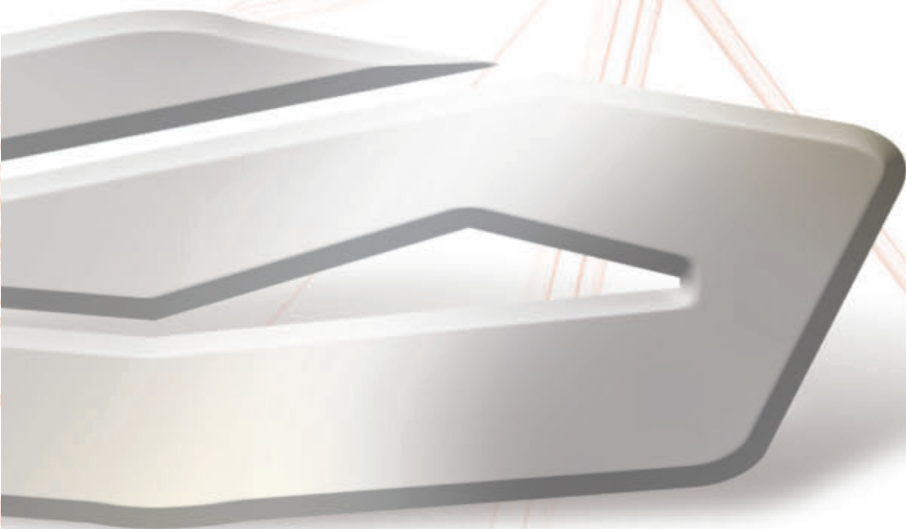



022-068
Eco-Friendly Building Material /
Minimum 20% Recycled Content

FORMDEX ADMIX

CRYSTALLIZATION WATERPROOFING ADMIXTURE

FORMDEX ADMIX is a chemical admixture in powdered form used in the waterproofing and protection of concrete structures.

FORMDEX ADMIX consists of Portland cement, fine treated silica sand and various active proprietary chemicals.

HOW DOES FORMDEX ADMIX WORK?

Formdex Admix is added to the concrete mix at the time of batching.

The active chemicals in Formdex Admix when combined with moisture in concrete and with the by-products of cement hydration to cause a catalytic reaction, which generates a non-soluble crystalline formation filling the naturally occurring pores and voids in concrete.

These crystals growth will permanently block the pathways for water even under high hydrostatic conditions.



◀ TRIAL MIX CONCRETE CUBES

Advantages

- Becomes an integral part of the concrete
- Waterproofing is permanent
- Resists high hydrostatic pressure from either positive or negative side of concrete
- Self-seal hair-line cracks up to 0.4mm
- Allows concrete to breathe
- Impervious to physical damage and deterioration
- Reduces construction scheduling time

Areas of Usage

- Basement structures
- Water Retaining structures
- Tunnels & Subways
- Foundations

SPECIFICATION DATA

COLOUR: Grey

TEXTURE: Powder

SLUMP: BS EN 12350-2

AIR CONTENT: BS EN 12350-7

BLEEDING: BS EN 480-4

DENSITY: BS EN 12390-7

SETTING TIME: BS EN 480-2

COMPRESSIVE STRENGTH:
BS EN 12350-3

WATER PENETRATION:
DIN 1048: Pt 5

CHLORIDE CONTENT:
< 0.03%
BS EN 480 -10

◉ Application Guidelines

Dosage Rate:

For waterproofing concrete, the recommended dosage rate of Formdex Admix is 0.8% by weight of cement.

Mixing:

Formdex Admix must be added to the concrete at the time of batching.

The sequence of procedures for addition will vary according to the type of batch plant operation and equipment. The following are some typical mixing guidelines.

Ready Mix Plant – Dry Batch Operation:

Add Formdex Admix in powder form to the drum of the ready - mix truck. Drive the truck under the batch plant and add 60% - 70% of the required water along with 140kg - 230kg of aggregate. Mix the material for 2-3 minutes to ensure Formdex Admix is distributed evenly through the mix. Add the balance of materials to the ready- mix truck in accordance with standard batch practices.

On Site Mix / Ready Mix Truck Operation:

Mix Formdex Admix with water to form very thin slurry (eg. 10 kg powder mixed with 12 litres of water). Pour the required amount of material into the drum of the ready-mix truck. The aggregate, cement and water should be batched and mixed in the plant in accordance with standard practices (taking into account the quantity of water that has already been placed in the ready-mix truck). Pour the concrete into the truck and mix for at least 5 minutes to ensure even distribution of Formdex Admix throughout the concrete.

Ready Mix Plant - Central Mixer:

Add Formdex Admix in powder form to the rock and sand, then mix thoroughly for 2 - 3 minutes before adding the cement and water. The total concrete mass should be blended using standard practices.

Note:

It is important to obtain a homogeneous mixture of Formdex Admix with the concrete. Therefore do not add dry Formdex Admix powder directly to wet concrete as this may cause clumping and thorough dispersion will not occur.

◉ Health & Safety

Spillage and tools should be cleaned with Kerosene or white spirit.



1. Weighing of proposed dosage



2. Dosing onto conveyor belt



3. Concrete mixed in

SECTIONAL DRAWINGS

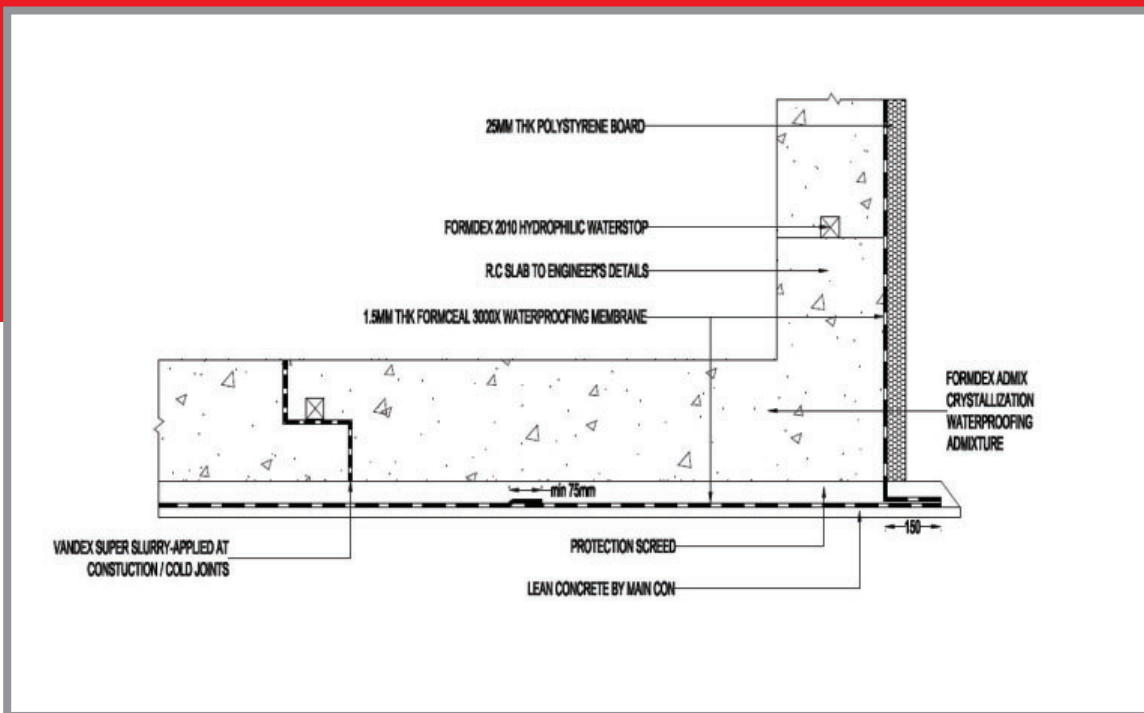
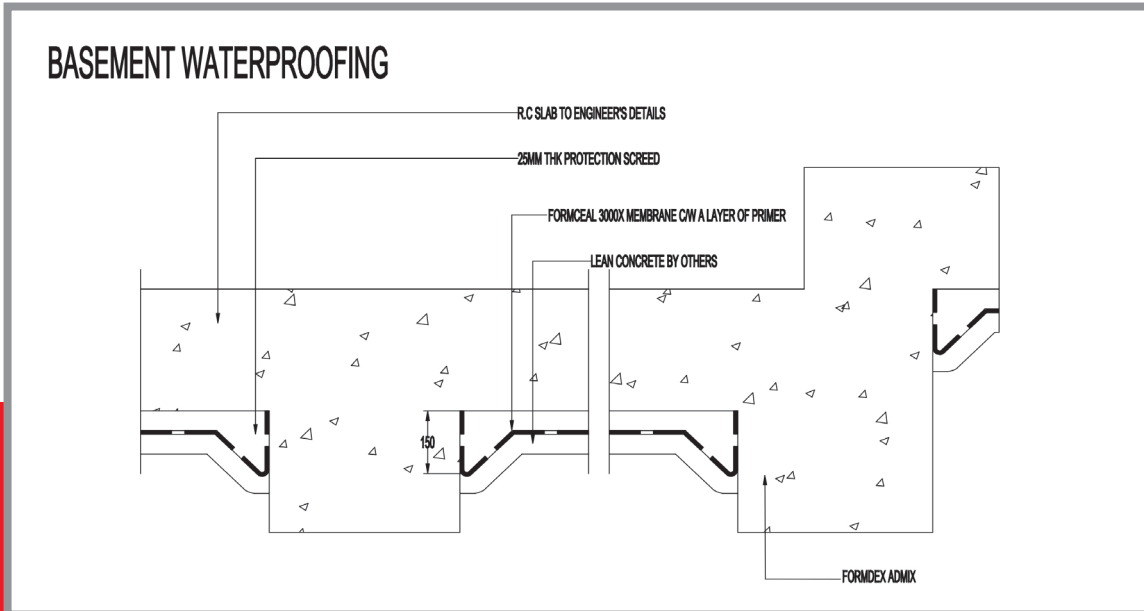

4. Compacting concrete for slump test



5. Measuring slump test result



6. Preparation of concrete cube

FORMDEX ADMIX



◀ COMPACTING CONCRETE CUBE



◀ CONCRETE BATCHING PLANT

WARRANTY INFORMATION

Only Hitchins' trained applicators are approved to undertake all application work. Hitchins products carry a long-term warranty for both materials and workmanship. The warranty is further backed by Hitchins International Fidelity Fund. Please check with our local applicators if this fund is available in your country. For complete warranty and other related information, please contact Hitchins regional offices.

Revision A

Hitchins



| Distribution Network

SINGAPORE

Hitchins (FE) Marketing Pte Ltd
30, Toh Guan Road #07-05
ODC District Centre
Singapore 608840
Telephone: (65) 6861 1177
Facsimile: (65) 6863 4240
Email: hitchins@hitchins.com

MALAYSIA

Hitchins (Malaysia) Sendirian Berhad
No. 26 Jalan 4/10B
Spring Crest Industrial Park 68100 Batu Caves, Selangor, Malaysia
Telephone: (60-3) 6185 8888
Facsimile: (60-3) 6185 0668
Email: hitchins@streamyx.com

CHINA

Shanghai Hitchins Da Sheng Waterproofing Materials Co., Ltd
No. 58, 699 Nong, Bei Qing Gong Lu Hua Cao Zhen, Ming Hang Qu Shanghai P.R.
China Post Code 201107
Telephone: (86-21) 62219815/7/9 Facsimile: (86-21) 6221 9812
Email: samkim@hitchins.com

BRUNEI

Hitchins (Borneo) Sendirian Berhad
P.O. Box 1675
Bandar Seri Begawan 1916
Telephone: (673-2) 652561
Facsimile: (673-2) 652563

Hitchins Approved Applicator



**WATERPROOFING
& BUILDING PROTECTION**

Hitchins (FE) Marketing Pte Ltd

Tel: (65) 6861 1177 Fax: (65) 6863 4240

Email: hitchins@hitchins.com [Http://www.hitchins.com](http://www.hitchins.com)